

New

# Essenza KDJ+S

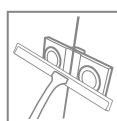

Profile finish:

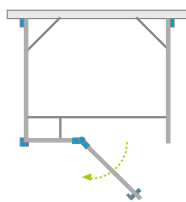

01 Chrome 54 Black



Essenza KDJ+S + Giaros D

Shower enclosure set consists of 3 parts: shower door and 2 sidewalls S1. Please specify all the article numbers when making an order.

## DOOR

| Model            | TRANSPARENT GLASS                        |   |
|------------------|--|---|
|                  | profile finish <b>CHROME</b><br>Art. No. | profile finish <b>BLACK</b><br>Art. No. |
| KDJ+S door 80 L  | 1385021-01-01L                           | 1385021-54-01L                          |
| KDJ+S door 80 R  | 1385021-01-01R                           | 1385021-54-01R                          |
| KDJ+S door 90 L  | 1385020-01-01L                           | 1385020-54-01L                          |
| KDJ+S door 90 R  | 1385020-01-01R                           | 1385020-54-01R                          |
| KDJ+S door 100 L | 1385022-01-01L                           | 1385022-54-01L                          |
| KDJ+S door 100 R | 1385022-01-01R                           | 1385022-54-01R                          |
| KDJ+S door 110 L | 1385023-01-01L                           | 1385023-54-01L                          |
| KDJ+S door 110 R | 1385023-01-01R                           | 1385023-54-01R                          |
| KDJ+S door 120 L | 1385024-01-01L                           | 1385024-54-01L                          |
| KDJ+S door 120 R | 1385024-01-01R                           | 1385024-54-01R                          |

## SIDEWALL S1

(the package includes 1 sidewall, remember to order 2 sidewalls when making an order)

| Model  | TRANSPARENT GLASS                        |   |
|--------|--|---|
|        | profile finish <b>CHROME</b><br>Art. No. | profile finish <b>BLACK</b><br>Art. No. |
| S1 70  | 384048-01-01                             | 384048-54-01                            |
| S1 75  | 384049-01-01                             | 384049-54-01                            |
| S1 80  | 384051-01-01                             | 384051-54-01                            |
| S1 90  | 384050-01-01                             | 384050-54-01                            |
| S1 100 | 384052-01-01                             | 384052-54-01                            |

# TECHNICAL DRAWINGS

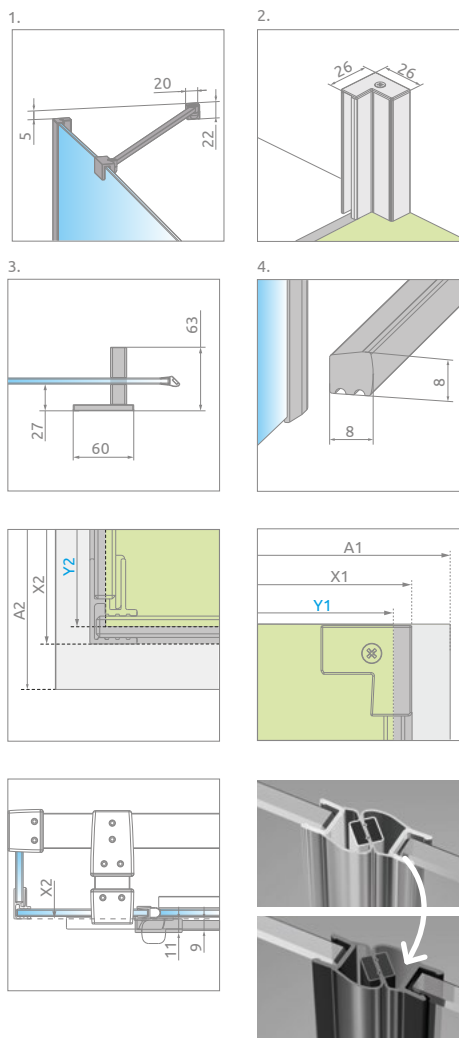
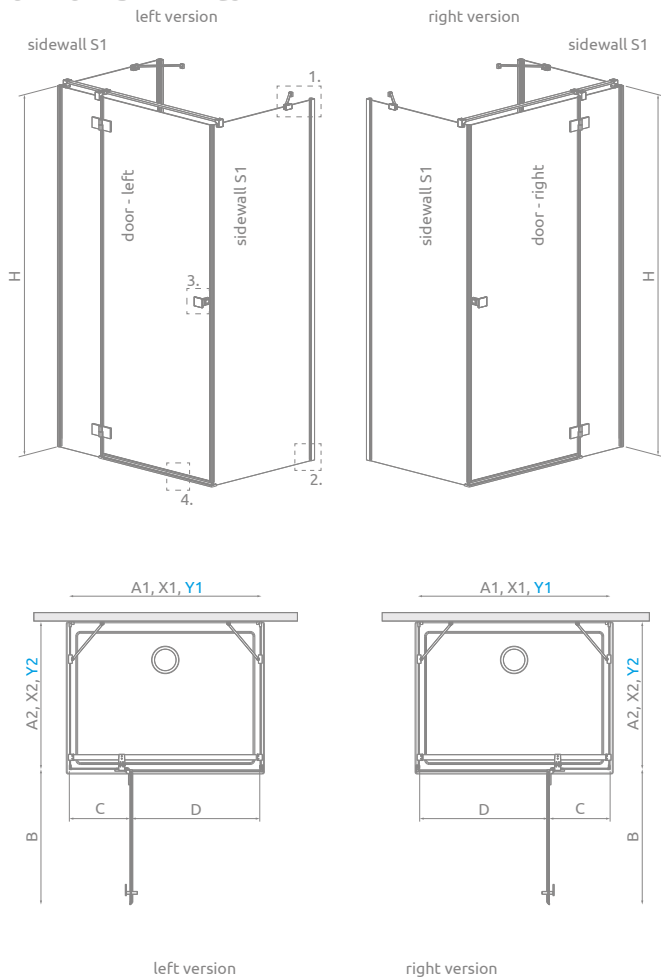

There is a possibility of a paid replacement of transparent gaskets for black gaskets:  
 - option no.1 - only magnetic gaskets,  
 - option no. 2 - all gaskets (magnetic, vertical and horizontal).  
 The selected option must be clearly stated in the order.

| Door      | A1   | X1   | Y1   | B   | C   | D   | H    | Sidewall S1 | A2   | X2      | Y2      |
|-----------|------|------|------|-----|-----|-----|------|-------------|------|---------|---------|
| KDJ+S 80  | 800  | 770  | 760  | 540 | 250 | 505 | 2000 | S1 70       | 700  | 672-687 | 667-682 |
| KDJ+S 90  | 900  | 870  | 860  | 640 | 250 | 605 | 2000 | S1 75       | 750  | 722-737 | 717-732 |
| KDJ+S 100 | 1000 | 970  | 960  | 640 | 350 | 605 | 2000 | S1 80       | 800  | 772-787 | 767-782 |
| KDJ+S 110 | 1100 | 1070 | 1060 | 840 | 250 | 805 | 2000 | S1 90       | 900  | 872-887 | 867-882 |
| KDJ+S 120 | 1200 | 1170 | 1160 | 840 | 350 | 805 | 2000 | S1 100      | 1000 | 972-987 | 967-982 |

## ADDITIONAL OPTIONS

|                         |                         |                                      |                             |                         |                                 |                       |   |
|-------------------------|-------------------------|--------------------------------------|-----------------------------|-------------------------|---------------------------------|-----------------------|---|
|                         |                         |                                      |                             |                         |                                 |                       |   |
| MADE TO MEASURE<br>p. 6 | GLASS VARIANTS<br>p. 15 | PRINT/ENGRAVING ON GLASS<br>p. 25/30 | EXTENSION PROFILES<br>p. 22 | MAXIMUM HEIGHT<br>p. 17 | HANDLE EXCHANGE OPTION<br>p. 17 | TOWEL HANGER<br>p. 18 | MAGNETIC GASKETS REPLACEMENT POSSIBILITY<br>p. 23 |

| Extension profiles | Art. No. | Chrom | Black         |
|--------------------|----------|-------|---------------|
|                    |          |       | Profile +2 cm |

## NAVIGATION

